

User Manual

LED Image-300



Check that the unit has not been damaged during transport



Read all cautions and warnings
prior to operation of this
equipment

Protection Against Fire



Fire

1. Maintain a minimum of 1 50cm distance from any type of flame
2. Replace fuse only with the specified type and rating
3. Do not install the unit to close a heat source
4. Make sure cable are properly secured away from unit movement
5. Maximum surface operating temperature 80°

Protection Against Electrical



Electrical

1. Disconnect power before servicing
2. The unit must be earthed (electronically grounded)

Protection Against Mechanical Hazards



Mechanical

1. Use safety chain when hanging unit
2. Use quality clamps or bolts when positioning unit
3. Do not open unit while it is on, risk of electrical shock

Fixture Structure

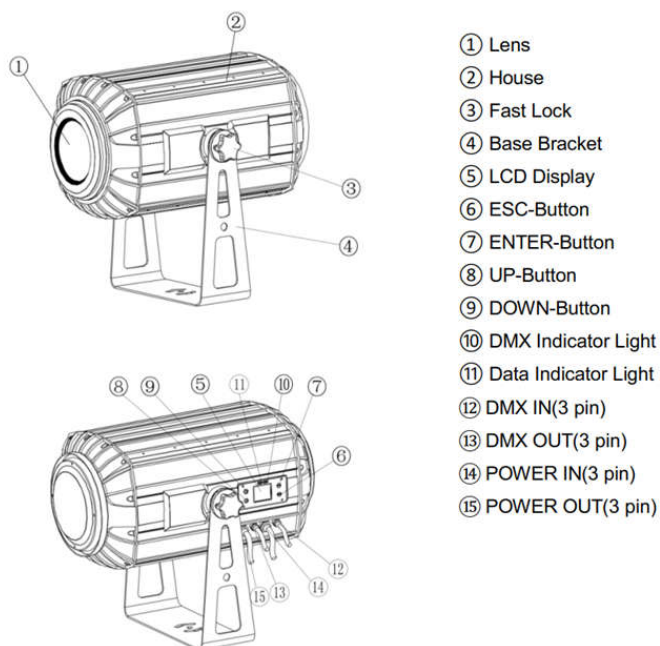

Dimension (mm):

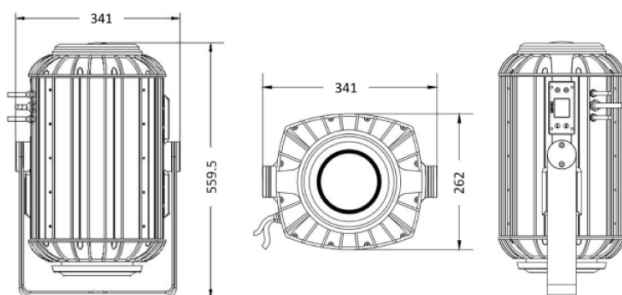

Photometric:

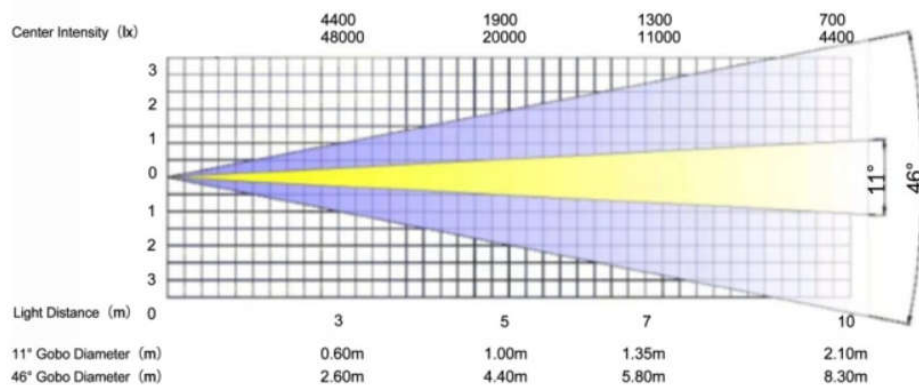

Technical Information

SOURCE

- Light Source: 300W Color White LED
- Color Temperature: 6500K
- Average LED Life: 20,000 Hour

POWER

- Input Voltage: 100-240VAC, 50/60Hz
- Power Consumption: 400W max. at full output

OPTICAL SYSTEM

- Zoom: 11°- 46° linear motorized
- Focus: Auto focus
- Strobe: 0-20Hz variable speed, synchronization, pulse and random strobe
- Dimmer: 0-100% variable linear dimming curves
- Prism: 3-facet prism

COLOR

- 6 Dichoric Colors plus open, Index / Shake / Bi-directional rotating rainbow effect

ROTATION GOBOS

- 6 inter-changeable glass gobos plus open, Shake / Bi-directional rotating rainbow effect
- 2 independent water streaks glass wheels

CONTROL / CONNECTION

- DMX Channel: 13CH
- Control Mode: DMX, Auto, Sound, Program
- DMX Input: 3-pin Male plug
- DMX Output: 3-pin Female plug

PHYSICAL

- Body Material: Aluminum
- IP Rate: IP65

WEIGHT / DIMENSION

- Net Weight: 15kg
- Dimension: 533×341×262mm

ACCESSORIES

- 1.5M Power Cable
- 1.5M DMX Cable
- Safety Cable
- Clamps optional



Main Power Connection

Caution!

1. Do not connect fixture to a dimmer system.
2. This unit has Auto switching power supply. It will respond to 110V or 220V automatically
3. This unit must be earthed. (Electronically grounded)
4. Replace fuse only with the specified type and rating.

The occupation of the connection-cable is as follows:

This fixture is equipped with an electronic power supply that will let the unit operate from 90V to 240V from 50Hz to 60Hz.

| Cable (USA) | Cable (EU) | Pin | 110V | 220V |
|-------------|--------------|---------|--|--|
| Black | Brown | Live | L | L |
| White | Light Blue | Neutral | N | N |
| Green | Yellow/Green | Ground |  |  |

110V
Connection

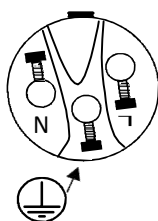

220V
Connection

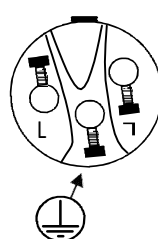

DMX-512 Connection

The fixture is equipped with 3 pin XLR Sockets for DMX input and output. The sockets are wired in parallel. Only use a shielded twisted pair cable designed for RS-485 and 3 pin XLR plugs and connectors in order to connect the controller with the fixture or the fixture with another.

DMX—input

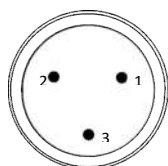

| |
|---------------|
| 1. Shield |
| 2. Signal (-) |
| 3. Signal (+) |

DMX—output

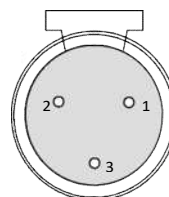

Mounting & Installation

- The fixture can be mounted in any fixed position.
- Always ensure that mounting surface can withstand 10 times the weight of the fixture.
- Always use a safety cable when mounting the fixture in any elevated position.

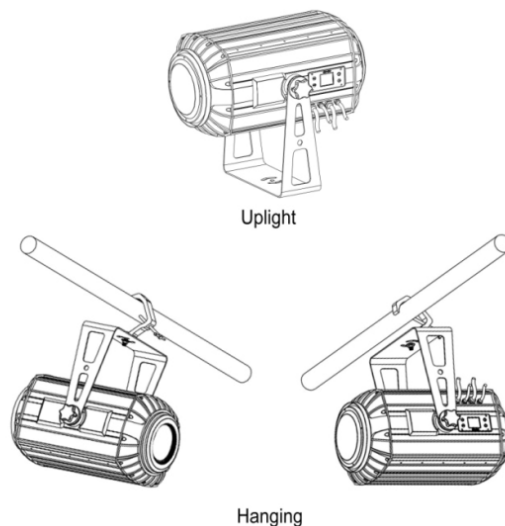

Important safety note!

Always use a safety cable when installing this unit!!

Be sure that the safety cable is connected to a solid load-bearing structure.

Fuse replacement

- Remove the safety cap by a screwdriver.
- Fetch the old fuse from safety cap.
- Install a new fuse.
- Install the safety cap.
- Fuse: 5A

Display Panel

Using the display panel to set the starting DMX address and set functions. The functions provided are described in the following sections.

【UP】 Scroll “Up” through the menu list or increase the value of the current function.

【DOWN】 Scroll “Down” through the menu list or decrease the value of the current function.

【ESC】 This key allows you turn back to main menu and select desired functions.

【ENTER】 This key allows you to confirm settings.

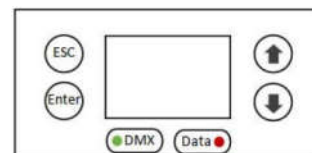

Menu Map

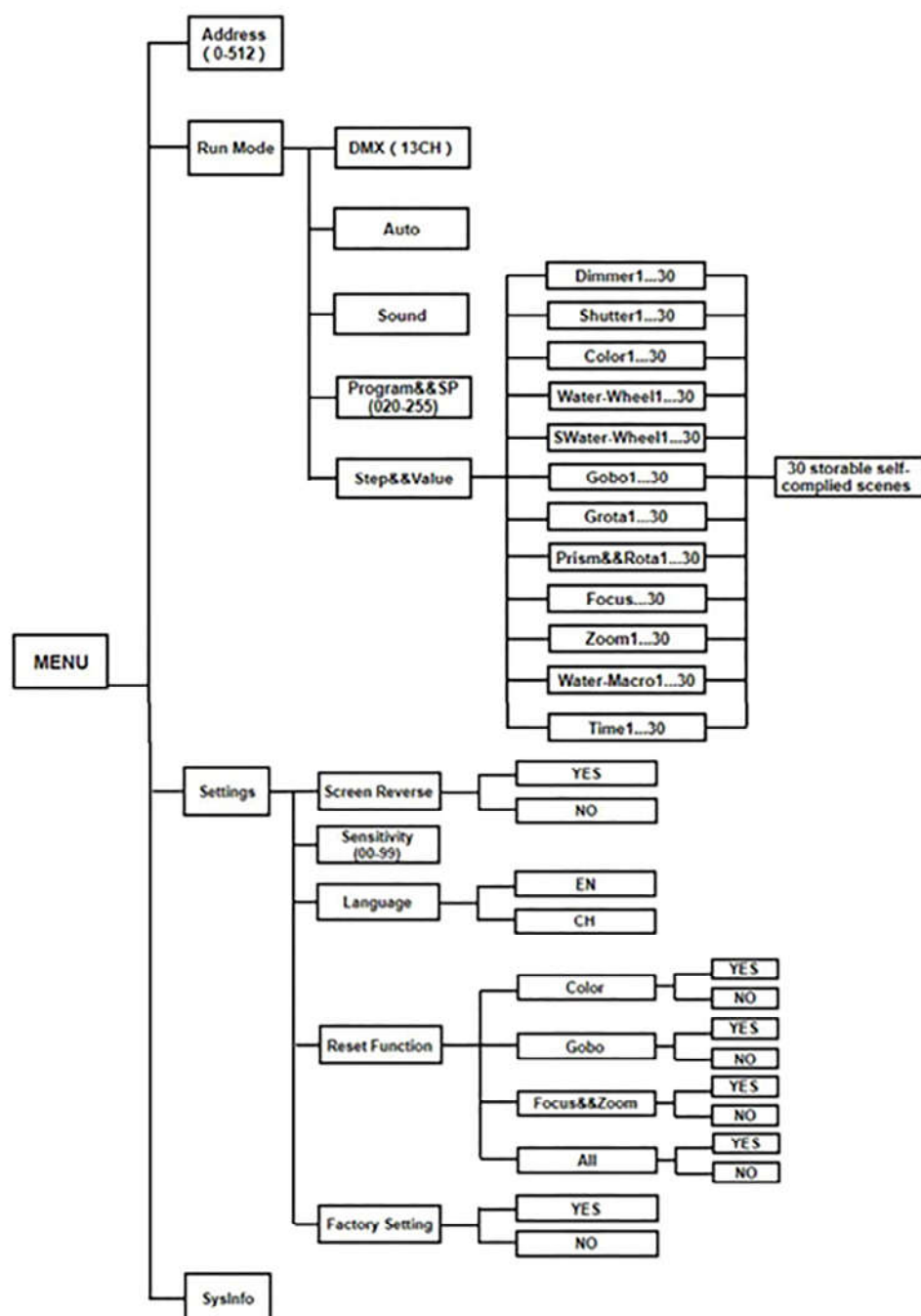

DMX Profile

| 13CH | Function | DMX Value | Description |
|------|----------------|-----------|----------------------------|
| 1 | Dimmer | 000-255 | 0-100% |
| 2 | Strobe | 000-003 | Close |
| | | 004-007 | Open |
| | | 008-076 | Strobe Slow to Fast |
| | | 077-145 | Pulse Strobe Slow to Fast |
| | | 146-215 | Random Strobe Slow to Fast |
| | | 216-255 | Open |
| 3 | Color Wheel | 000-008 | Open |
| | | 009-017 | Color 1 |
| | | 018-026 | Color 2 |
| | | 027-035 | Color 3 |
| | | 036-044 | Color 4 |
| | | 045-053 | Color 5 |
| | | 054-062 | Color 6 |
| | | 063-082 | Open+Color 1 |
| | | 083-100 | Color 1+ Color 2 |
| | | 101-118 | Color 2+ Color 3 |
| | | 119-135 | Color 3+ Color 4 |
| | | 136-154 | Color 4+ Color 5 |
| | | 155-172 | Color 5+ Color 6 |
| | | 173-189 | Color 6+ Open |
| | | 190-220 | Forward Fast to Slow |
| | | 221-224 | Stop |
| | | 225-255 | Backward Slow to Fast |
| 4 | Water Streak 1 | 000-007 | Open |
| | | 008-015 | Water Streak 1 |
| | | 016-255 | Rotation |
| 5 | Water Streak 2 | 000-007 | Open |
| | | 008-015 | Water Streak 2 |
| | | 016-255 | Rotation |
| 6 | Gobo Wheel | 000-008 | Open |
| | | 009-017 | Gobo 1 |
| | | 018-026 | Gobo 2 |
| | | 027-035 | Gobo 3 |
| | | 036-044 | Gobo 4 |
| | | 045-053 | Gobo 5 |
| | | 054-062 | Gobo 6 |
| | | 063-082 | Open+Gobo 1 |
| | | 083-100 | Gobo 1+ Gobo 2 |

| | | | |
|----|-----------------------|---------|-------------------------------------|
| | | 101-118 | Gobo 2+ Gobo 3 |
| | | 119-135 | Gobo 3+ Gobo 4 |
| | | 136-154 | Gobo 4+ Gobo 5 |
| | | 155-172 | Gobo 5+ Gobo 6 |
| | | 173-189 | Color 6+ Open |
| | | 190-220 | Forward Fast to Slow |
| | | 221-224 | Stop |
| | | 225-255 | Backward Slow to Fast |
| 7 | Gobo Rotation | 000-063 | Rotating Gobo Direction |
| | | 064-145 | Backward Slow to Fast |
| | | 146-149 | Stop |
| | | 150-231 | Forward Slow to Fast |
| | | 232-255 | Rainbow Effect Slow to Fast |
| 8 | Gobo Rotation Fine | 000-255 | 16bit adjustment |
| 9 | Prism | 000-015 | Open |
| | | 016-032 | Prism |
| | | 033-159 | Backward Slow to Fast |
| | | 160-167 | Stop |
| | | 168-255 | Forward Fast to Slow |
| 10 | Zoom | 000-255 | 11-46degree |
| 11 | Focus | 000-255 | Far to Near |
| 12 | Water Streak Rotation | 000-007 | Open |
| | | 008-255 | Water Streaks Rotation Slow to Fast |
| 13 | Reset | 000-095 | No Function |
| | | 096-111 | Reset |
| | | 112-255 | No Function |

Cleaning!

Due to fog residue, smoke, and dust cleaning the internal and external optical lenses must be carried out periodically to optimize light output.

1. Use normal glass cleaner and a soft cloth to wipe off the outside casing.
2. Clean the external optics with glass cleaner and a soft cloth every 20 days.
3. Always be sure to dry all parts completely before plugging the unit back in.

Cleaning frequency depends on the environment in which the unit operates (i.e. smoke, fog residue, dust, dew).

Unit not responding to DMX:

Check that the DMX cables are connected properly and are wired correctly (pin 3 is "hot"; on some other DMX devices pin 5 may be "hot"). Also, check that all cables are connected to the right connectors; it does matter which way the inputs and outputs are connected.